



ISO 9001



Approved



Approved

## ROUND TURNBUCKLE - OPEN BODY

- TO DIN 1480

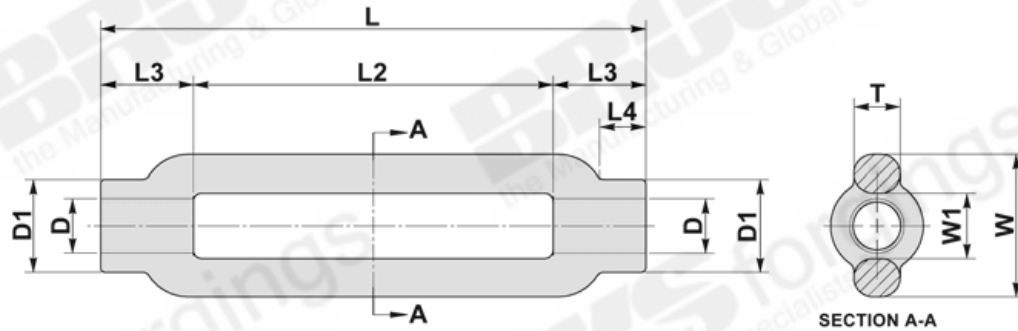

D	L	L2	L3	L4	W	W1	T	D1
Thread	mm	mm	mm	mm	mm	mm	mm	mm
M6	110	86	12	6	19	9	6	12
M8	110	80	15	8	23	11	8	15
M10	125	89	18	9	30	14	9	18
M12	125	83	21	11	34	16	11	21
M16	170	116	27	14	42	20	14	27
M20	200	132	34	17	52	24	17	34
M24	255	177	39	20	60	28	20	39
M30	255	165	45	23	74	34	23	45
M36	295	185	55	28	86	40	28	55
M42	330	204	63	32	104	50	32	63
M48	355	199	78	39	135	65	40	80
M56	355	199	78	39	135	65	40	80

**MATERIAL**

**CARBON STEELS**  
**STAINLESS STEELS**  
**ALLOY STEELS**  
**B7, 4.6, 5.6, 8.8**

**FINISH**

**SELF COLOUR**  
**GALVANISED**  
**ELECTROPLATED**  
**SHERARDISED**  
**PTFE COATING**

